

1958 | Village Center Circle Las Vegas, NV 89134

NWC Village Center & Trailwood Dr

SUBLEASE ±2,275 SF

- In-line branch located in a CVS Pharmacy and Vons supermarket anchored retail center
- Part of a successful retail center in the heart of the Summerlin community
- Great access to the Summerlin Pkwy, I-215 and US95 freeways

	1 Mile	3 Mile	5 Mile
Population	14,820	123,599	307,621
Ave HH Income	\$128,759	\$90,867	\$80,805
Households	5,743	49,970	120,736

Traffic Counts

Summerlin Pkwy 52,000 cars daily

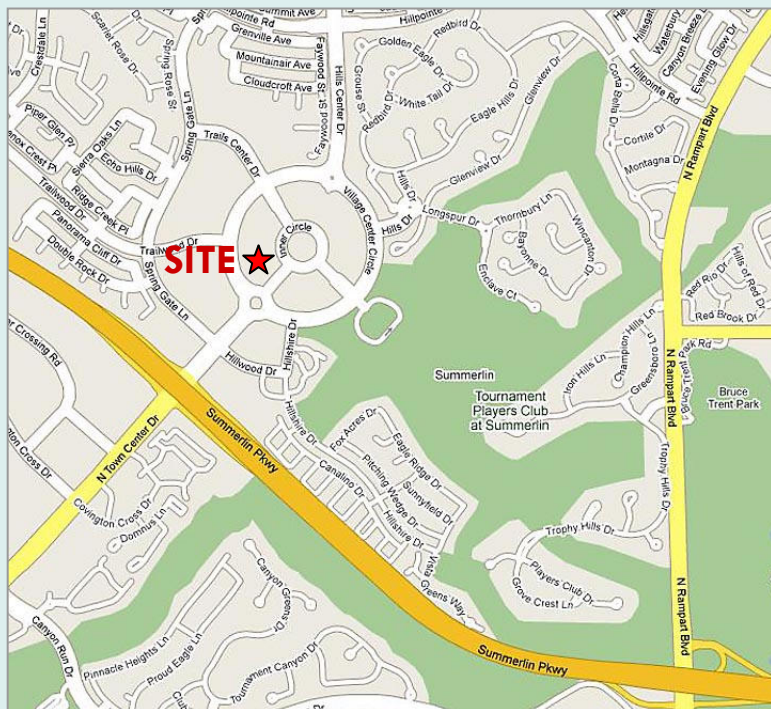

FOR MORE INFORMATION PLEASE CONTACT:

TODD BOYER
 tboyer@roicre.com
 702.363.3100 EXT 106

7100 W Smoke Ranch Rd
 Suite 100
 Las Vegas, NV 89128

Phone: 702.363.3100
 Fax: 702.363.0450
 www.roicre.com

Leasing | Tenant Representation | Investment Sales | Land Acquisition

The information contained herein was obtained from sources believed reliable. However, R.O.I. Commercial Real Estate, Inc. makes no guaranties, warranties, or representations as to the completeness or accuracy thereof. The presentation of this information submitted is subject to errors, omissions, and/or changes without notice.

Aerial

NWC Village Center & Trailwood Dr

SUBLEASE $\pm 2,275$ SF

1958 | Village Center Circle
Las Vegas, NV 89134

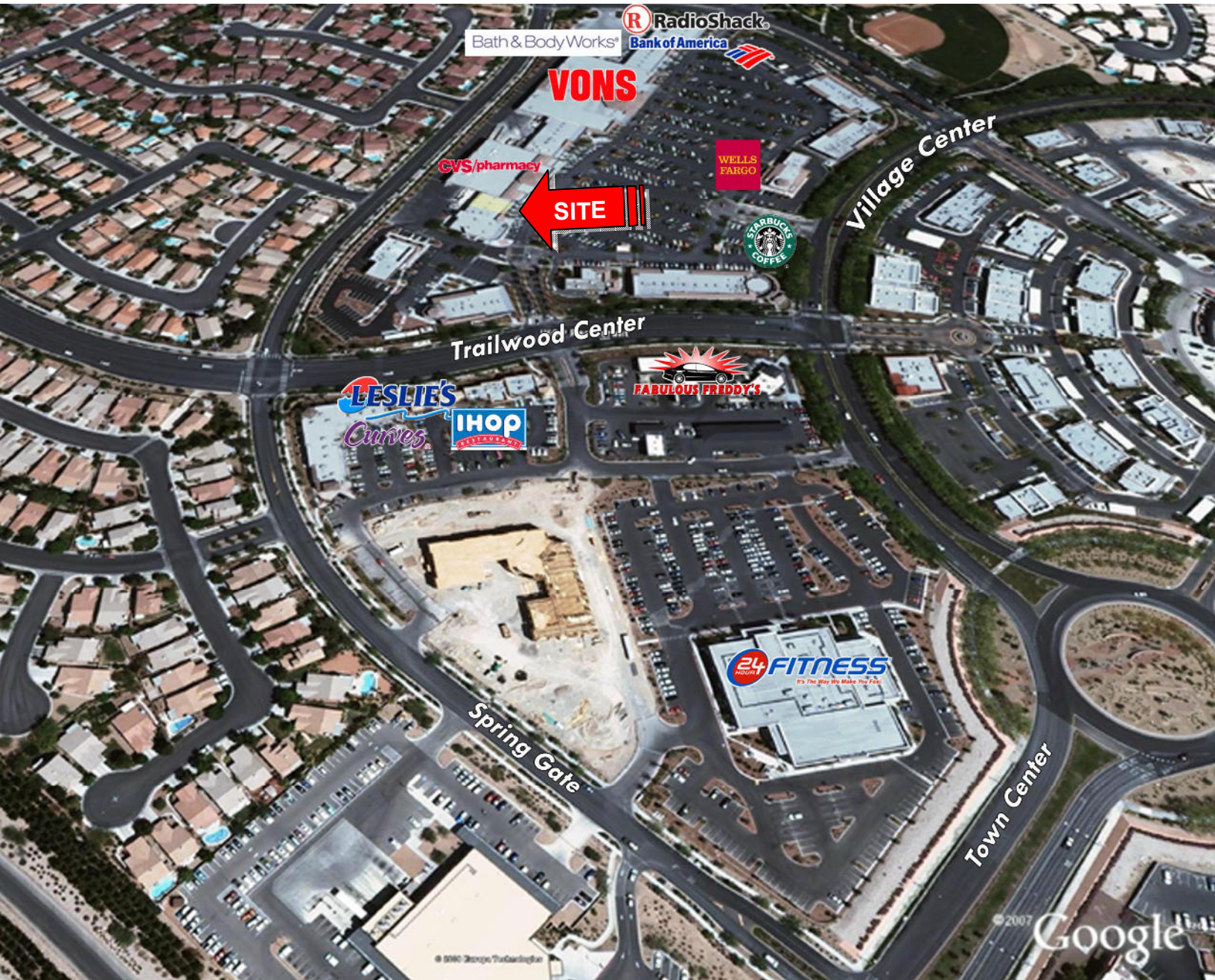

FOR MORE INFORMATION PLEASE CONTACT:

TODD BOYER

tboyer@roicre.com

702.363.3100 EXT 106

The information contained herein was obtained from sources believed reliable. However, R.O.I. Commercial Real Estate, Inc. makes no guaranties, warranties, or representations as to the completeness or accuracy thereof. The presentation of this information submitted is subject to errors, omissions, and/or changes without notice.

Site Plan

NWC Village Center & Trailwood Dr

SUBLEASE ±2,275 SF

1958 | Village Center Circle
Las Vegas, NV 89134

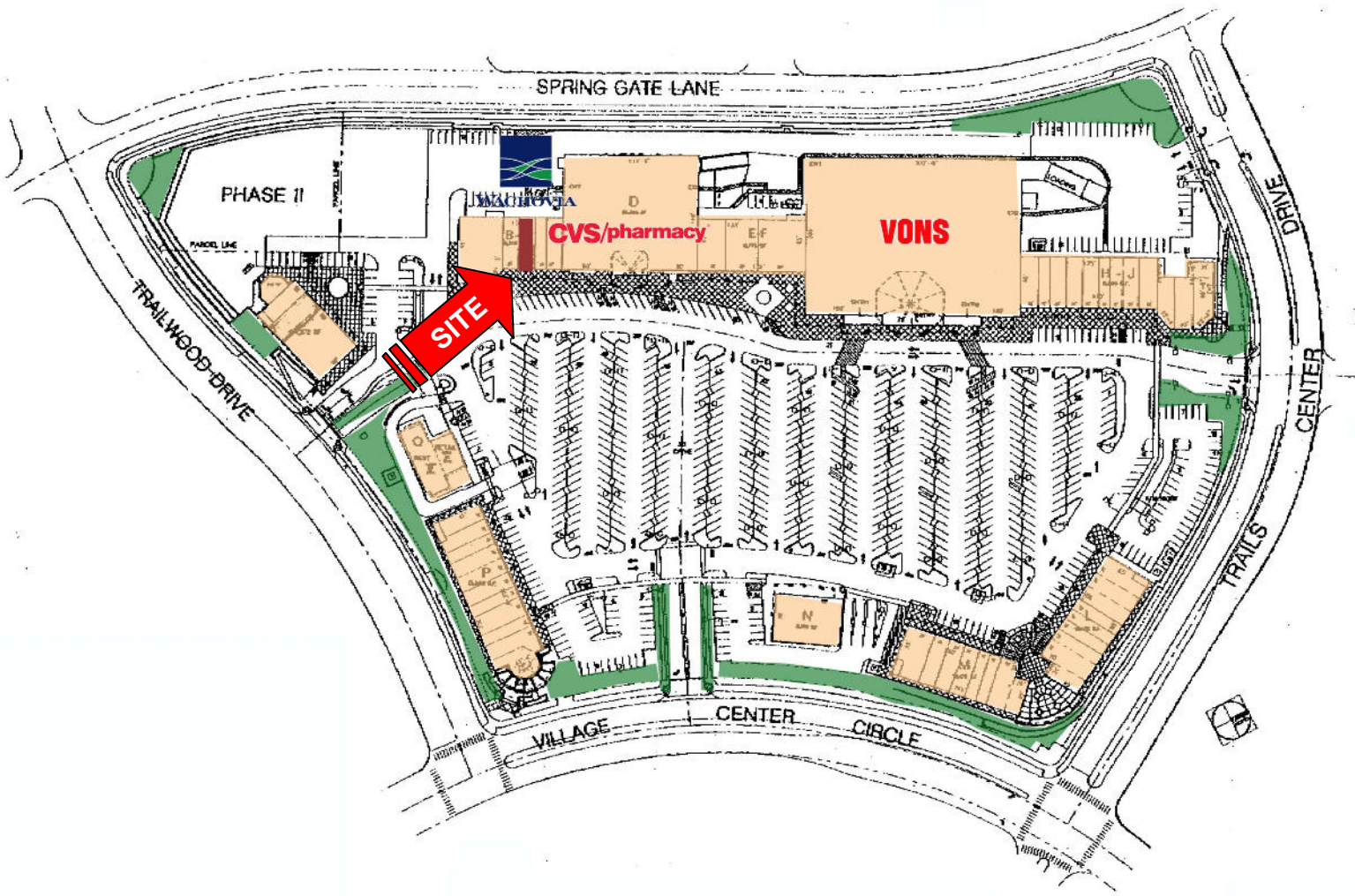

FOR MORE INFORMATION PLEASE CONTACT:

TODD BOYER

tboyer@roicre.com

702.363.3100 EXT 106

The information contained herein was obtained from sources believed reliable. However, R.O.I. Commercial Real Estate, Inc. makes no guaranties, warranties, or representations as to the completeness or accuracy thereof. The presentation of this information submitted is subject to errors, omissions, and/or changes without notice.